



Exquisite Collection
Wall-Mounted Single Lever
Shower Mixer

Model: KEF-15108

Exquisite Collection
Wall-Mounted Single Lever Shower Mixer

Model: KEF-15108

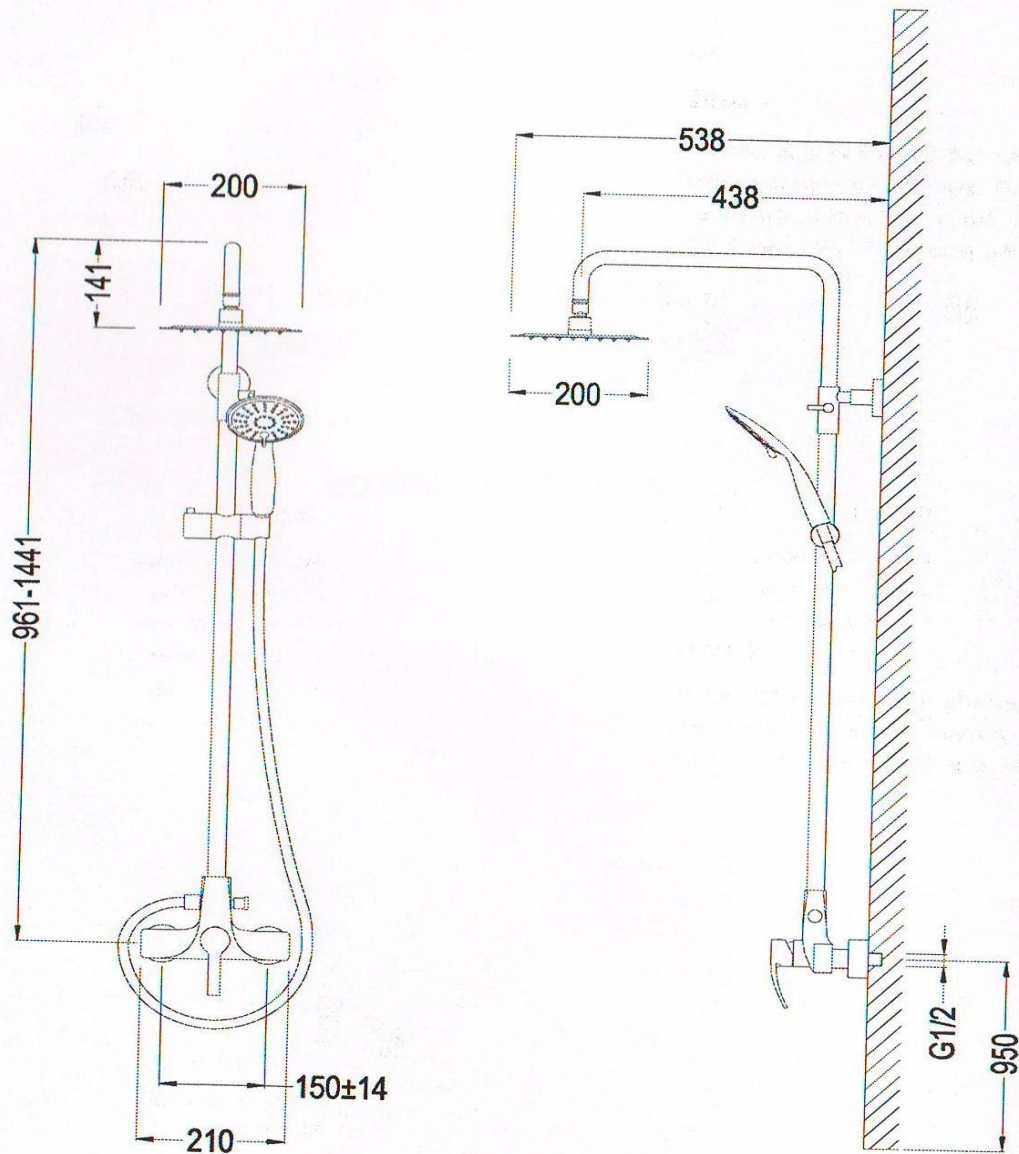

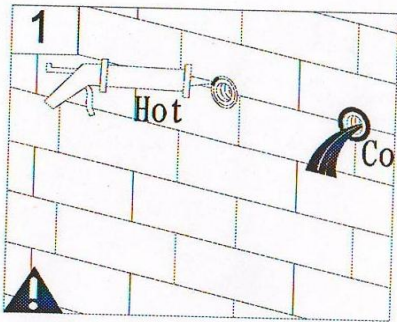

Step 1

Fill the gap between the wall and the outlet hole with silicone. Turn on the valve and allow the water to run freely for 5 minutes. Then turn off the valve.

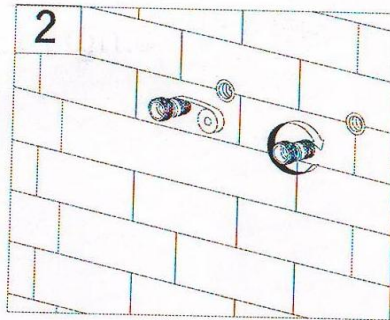

Step 2

Wrap the bended connector with Teflon tape. Then screw it into the outlet hole.

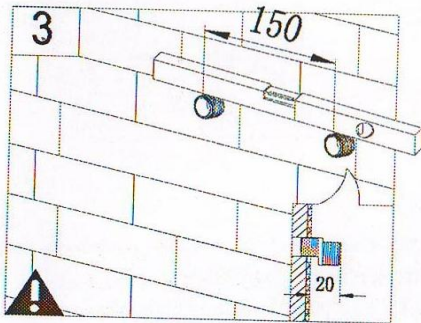

Step 3

Adjust the position of the two bended connectors to be horizontal, and make sure the center distance is 150 mm.

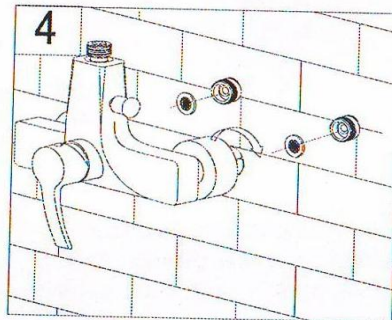

Step 4

Put the washer onto the bended connector. Lock the fixing nut to tighten the mixer body. Push the flange to the wall in the right position.

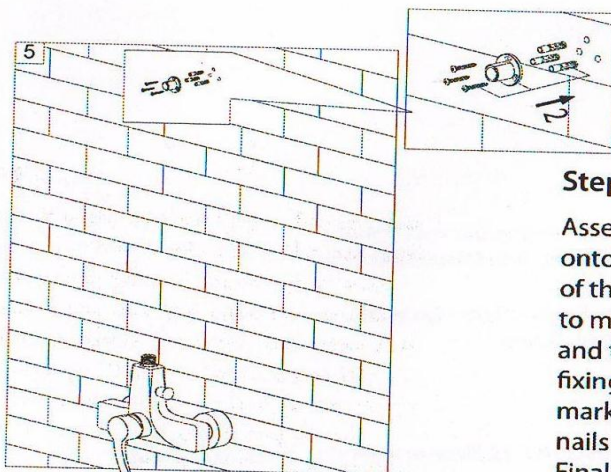

Step 5

Assemble the straight pipe, fixing plate onto the mixer body, mark the position of the fixing plate (Please use a level to make the straight pipe be vertical) and then remove the straight pipe and fixing plate. Drill 2x Ø6 holes at the marked position. then knock the plastic nails in and install the fixing plate. Finally, put flange onto the fixing plate.

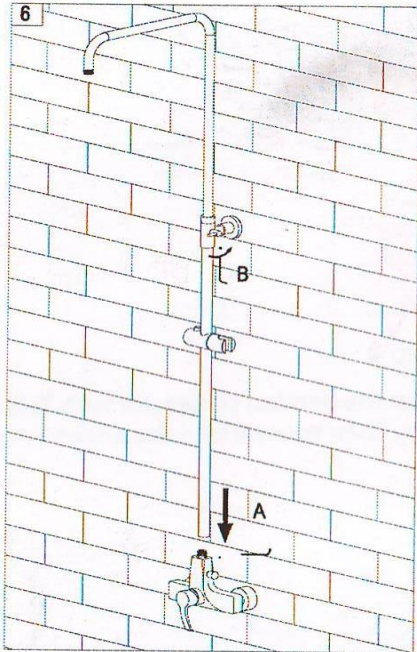

Step 6

Screw the straight pipe into the corresponding screw thread of the mixer body and fix with subcrew tightly. Insert the connector of the straight pipe into the fixing plate, then place straight pipe vertical and fix with setwcrew tightly.

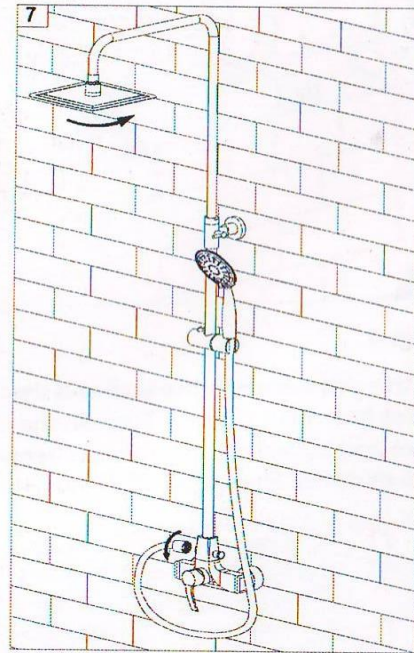

Step 7

Install the head shower. Screw one end of the hose to the mixer body, another end to the hand shower, then place the hand shower on the bracket.

Help Line

If you need additional assistance at any time during the installation, please call us at: **1.800.775.0703** or email us at: **info@kraususa.com**

Our customer service hours are **Monday - Friday, 9am - 6pm EST.**
Be sure to visit our website at: **www.kraususa.com**



**KrausUSA / 12 Harbor Park Dr,
Port Washington, NY, 11050**

**Questions?
Call Us: 1.800.775.0703**